

### KIT FEATURES

- ▶ ISO and DIN head unit provisions
- ▶ Pocket (holds 2 jewel cases)

### KIT COMPONENTS

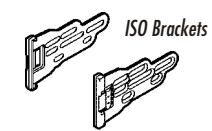
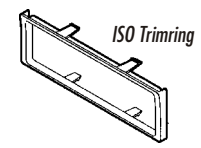
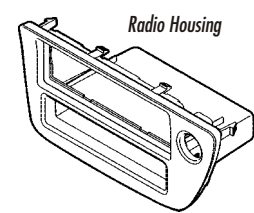

### TOOLS REQUIRED



# 99-7867

## INSTALLATION INSTRUCTIONS

### APPLICATIONS

<u>CAR</u>	<u>PAGE</u>
ACURA RSX 2002.....	1-2



## ALL VEHICLES

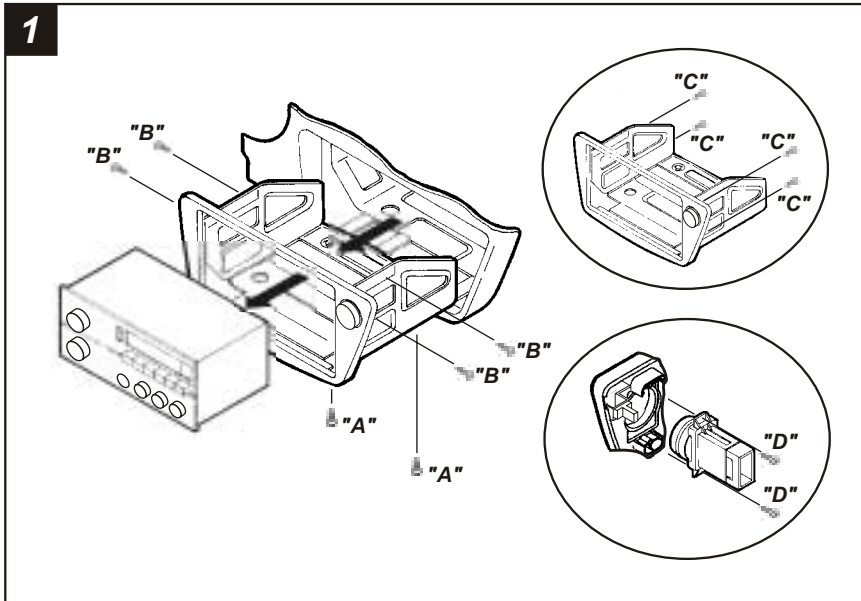

Disconnect the negative battery terminal to prevent an accidental short circuit. Unclip the lower dash panel (containing the power outlet) and remove the panel. Reach into the opening and remove (2) Phillips screws from the base of the factory head unit ("A"). Slide the factory head unit (w/ bracket assembly) from the dash and disconnect the wiring. Remove (4) Phillips screws securing the factory head unit to the bracket assembly and remove the unit ("B"). (If a factory pocket is present, remove (4) Phillips screws securing the pocket to the bracket assembly and remove). Remove (4) Phillips screws securing the bracket assembly to the back of the radio trim bezel and remove the bezel ("C"). Remove (2) Phillips screws securing the hazard switch to the back of the radio trim bezel and remove the switch ("D").

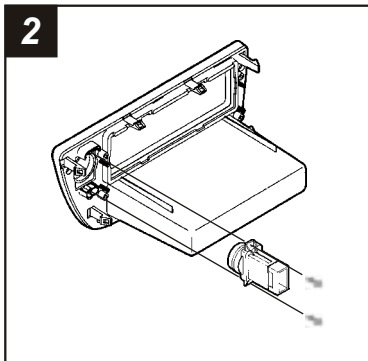

Mount the hazard switch to the back of the **Radio Housing** with (2) Phillips screws previously removed in step #1.

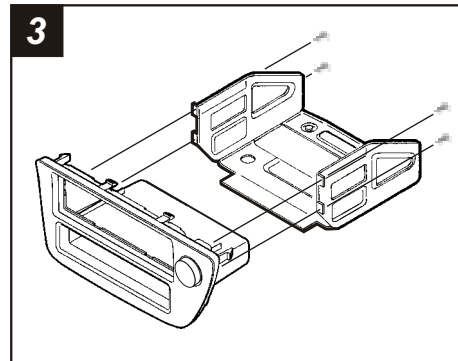

Mount the factory bracket assembly to the back of the **Radio Housing** with (4) Phillips screws previously removed in step #1.

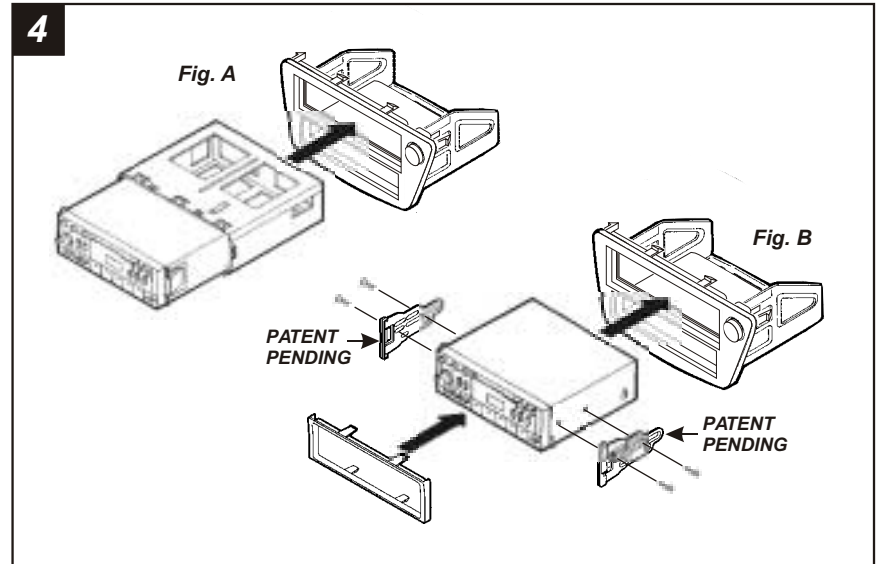

**DIN HEAD UNITS:** Slide the DIN cage into the kit and secure by bending the metal locking tabs down. Slide the aftermarket head unit into the cage until secure. (see Fig. A)

**ISO HEAD UNITS:** Secure the **ISO Brackets** to the sides of the aftermarket head unit with the screws supplied with the unit. Slide the head unit assembly into the **Radio Housing** until the side clips engage and attach the **ISO Trimming** over the mounted head unit. (see Fig. B).

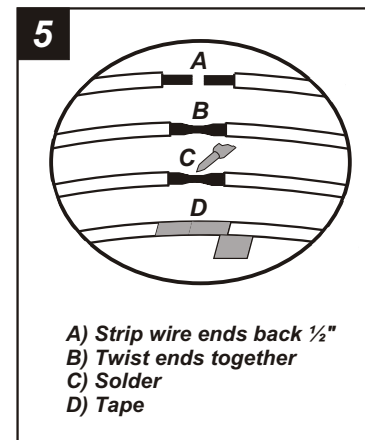

Locate the factory wiring harness in the dash. Metra recommends using the proper mating adaptor and making connections as shown. (Isolate and individually tape off the ends of any unused wires to prevent electrical short circuit).

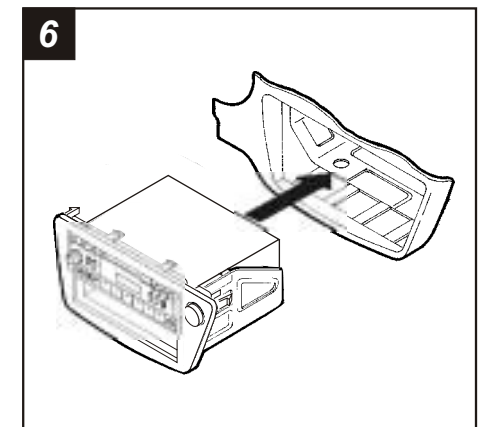

Re-connect the battery terminal and test the unit for proper operation. Re-connect the hazard switch plug and snap the head unit/kit assembly into the sub-dash.